



# 250 Tower

250 East 200 South



## Space availability summary

WeWork @ 250 East 200 South  
Salt Lake City, UT

**wework**

[VIEW VIRTUAL TOUR](#)

16th Floor 22,197 RSF

15th Floor 22,116 RSF

**44,313 RSF**

TOTAL WEWORK RSF

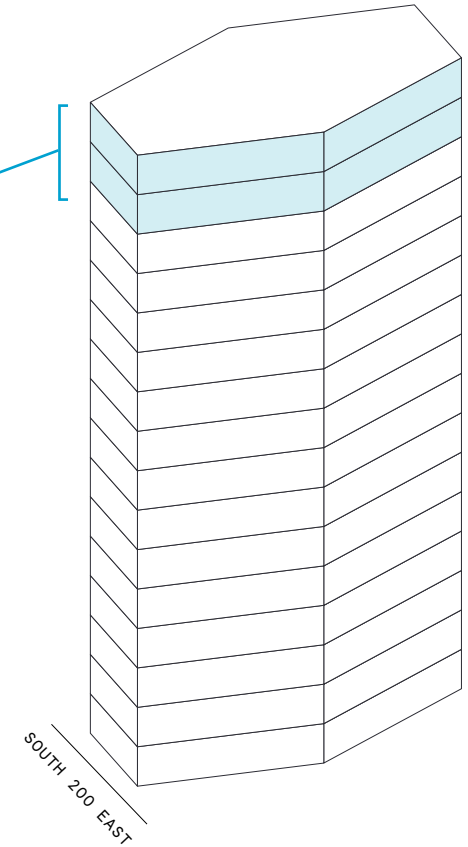

**250 Tower**

At a glance

Workspaces designed for productivity and creativity with flexible size & term

Dedicated, private offices available from 73 to 4,786 RSF

Move-in ready suites furnished & wired

**16**

TOTAL BUILDING FLOORS

**354,342**

TOTAL BUILDING SQ FT

All dimensions are approximate and subject to variances. It is your obligation to independently verify the particulars of the property. WeWork reserves the right to make changes.





Both the design and materials used throughout 250 Tower take their inspiration from Utah's natural beauty.



Calm, inviting color palettes and textures contribute to a relaxed atmosphere throughout the space.

## A modern workspace in a welcoming neighborhood

---

250 East 200 South is a 16-story, Class-A building centrally located in downtown Salt Lake City. Completed in 1984, this glass-sided tower is known for its comfortable meeting rooms, expansive, light-filled lounges, and an outdoor terrace with spectacular views of the neighboring scenery, including the Wasatch Mountains. WeWork's flexible workspace takes full advantage of this view, with much of the workspace's design aesthetic drawing on the natural parks and landscapes surrounding the greater Salt Lake area.





Oversized panoramic windows fill common spaces and offices with natural light and provide sweeping views of the Wasatch Mountains.



Spacious wellness room with plush furniture is the perfect spot to take a break.



# Natural splendor meets modern design

250 Tower combines naturally inspired materials and motifs with professional polish, creating a space that invites productivity, creativity, and collaboration.

- The overall color palette features muted neutrals with pops of jewel-toned accents, reflecting the hues of the surrounding natural landscape
- A mix of contemporary and classic design elements and materials creates visual variety and interest
- Custom murals, textiles, furnishings, and artwork inspired by local architecture and culture are featured throughout the space

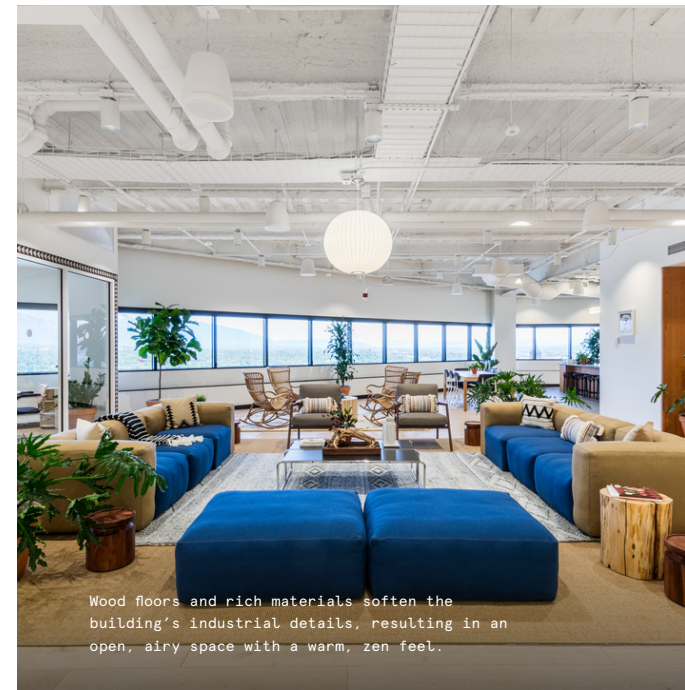





## On-site amenities

- 24/7 security
- Electronic keycard access
- Business-class printers
- Professional and social events
- Coffee service
- US mail drop
- Private meeting rooms
- New parent's room
- Wellness/meditation room
- Event space
- Showers
- Gender-neutral restrooms in gym
- Phone booths
- Dog-friendly spaces
- Bicycle storage
- On-site parking
- Emergency back-up power
- Outdoor space
- Fitness center



# Building specifications

---



## Hours of operation

---

Monday – Friday: 8am–5pm



## Security

---

24/7 attended lobby

24/7 CCTV monitoring



## Certifications

---

LEED EB Gold certified

Fitwel Viral Response certified



## Building history

---

Built in 1984



## Ceiling heights

---

15th floor: 15 feet slab-to-slab

16th floor: 20 feet slab-to-slab



## HVAC

---

Monday – Friday: 8am–5pm

Saturday: 7am–1pm



## Building size

---

16 stories

354,342 SF



## Elevators

---

6 passenger elevators

1 freight elevator



## Fire strategy

---

Fully-sprinklered floors









# An all-access pass to downtown Salt Lake City

With its easily accessible location just two blocks from downtown Salt Lake City's Central Business District, 250 East 200 South offers no shortage of things to see and do.

Though it maintains a small-town atmosphere and charm, the area boasts a variety of attractions. Members can entertain clients with a Jazz game at the Vivint Smart Home Arena, head to the famed Beer Bar for drinks with a coworker, or take an after-work stroll past the Utah State Capitol Building. What's more, commuting is quick and easy, with on-site parking, bike storage, and the Trax at nearby Gallivan Plaza Station.

## Distance to WeWork

Library Station (TRAX)	 Walk	8 min
Gallivan Plaza Station (TRAX Salt)	 Walk	10 min
Salt Lake City International Airport	 Drive	10 min
City Center Station (TRAX Salt Lake/Sandy)	 Walk	12 min
Courthouse Station (TRAX)	 Walk	16 min
Temple Square Station (TRAX Salt)	 Walk	18 min

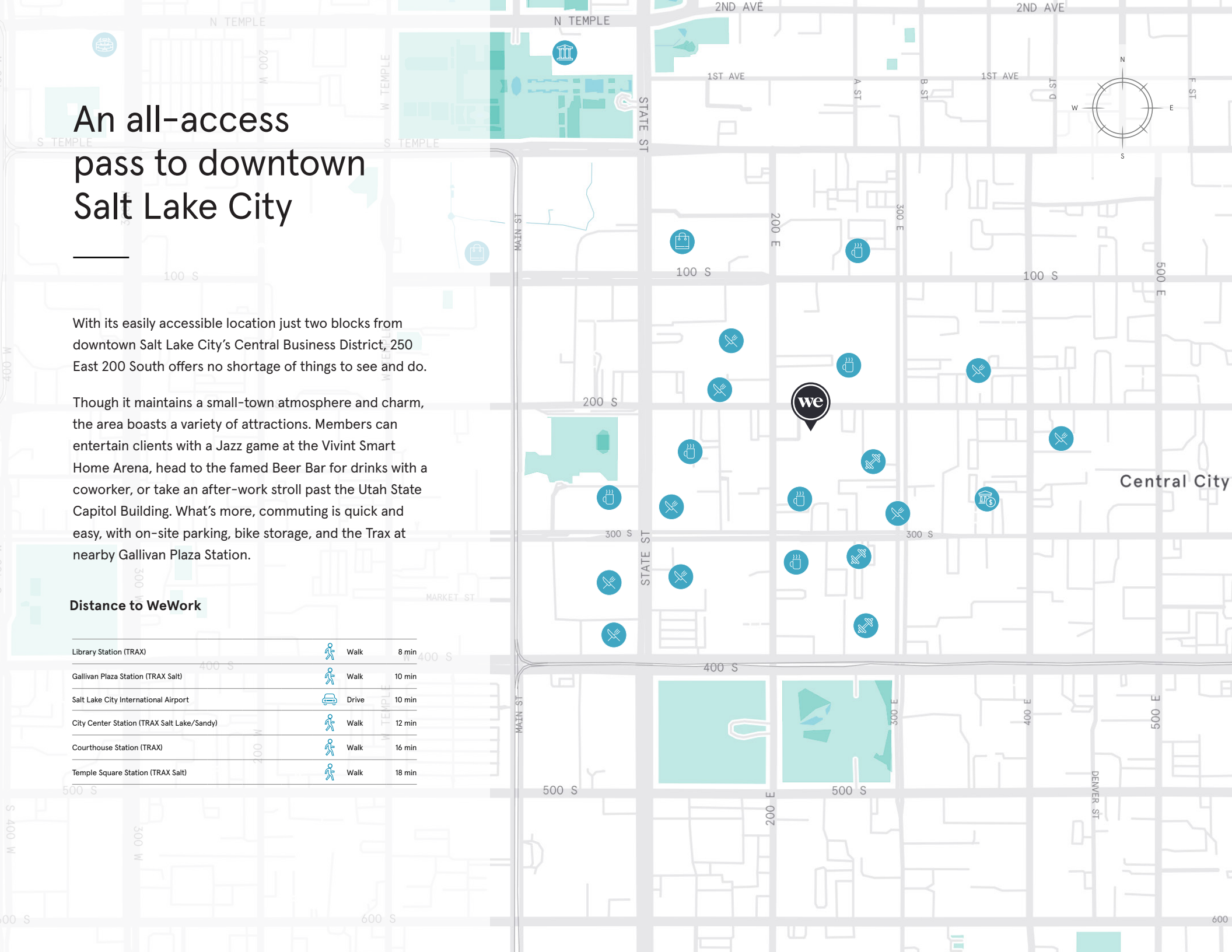

# 15th Floor

22,116 RSF

6

MEETING ROOM(S)

4

SHARED WORKSPACE(S)

## LEGEND

- MEETING ROOM
- SHARED WORKSPACE
- DEDICATED SPACE

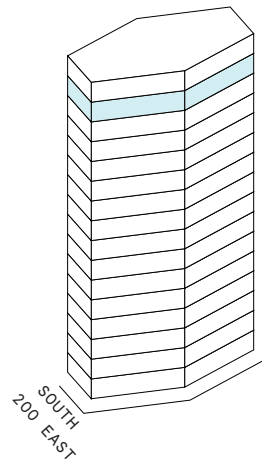

200 SOUTH

SOUTH 200 EAST

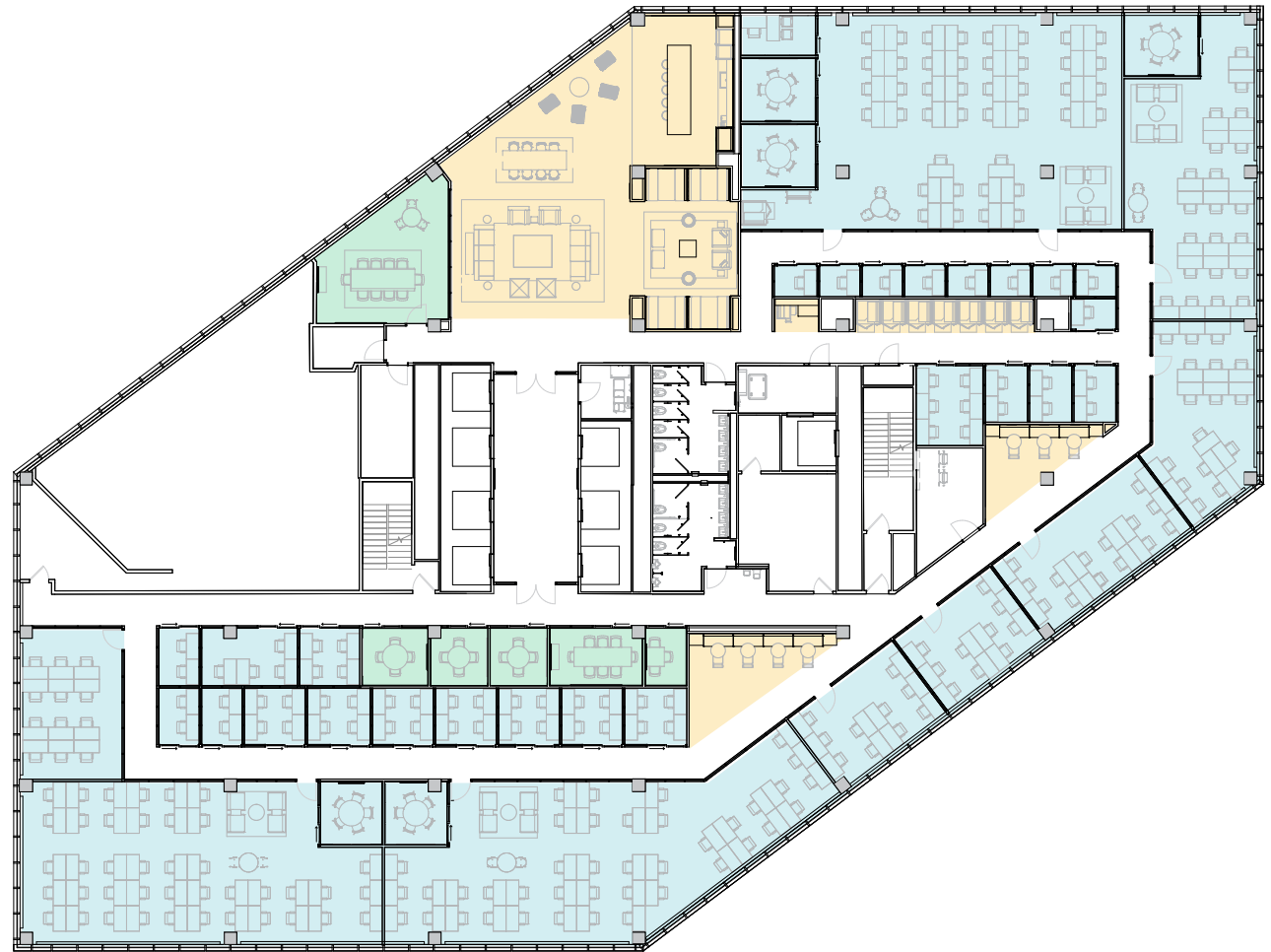



# 15th Floor

22,116 RSF

4,731 RSF Suite 15-102

2

MEETING ROOM(S)

1

PRIVATE OFFICE(S)



200 SOUTH

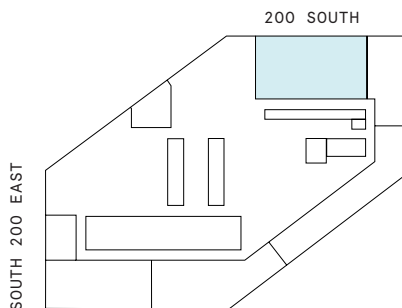

# Suite 15-102

## 15th Floor

[VIEW VIRTUAL TOUR](#)

2

MEETING ROOM(S)

1

PRIVATE OFFICE(S)

4,731 RSF

RENTABLE AREA

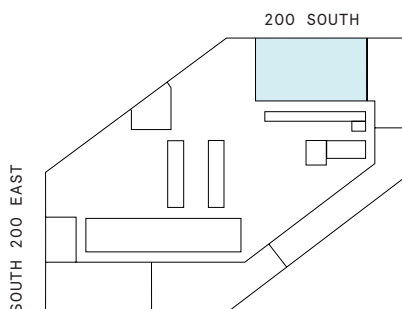
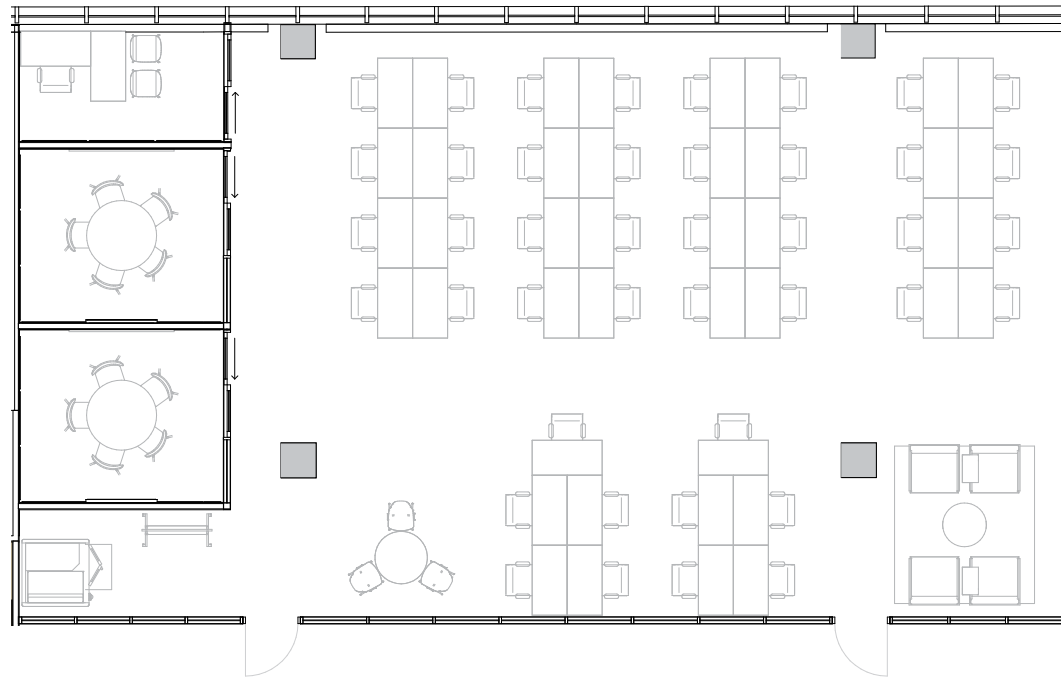



# 15th Floor

22,116 RSF

2,185 RSF Suite 15-111

1

MEETING ROOM(S)

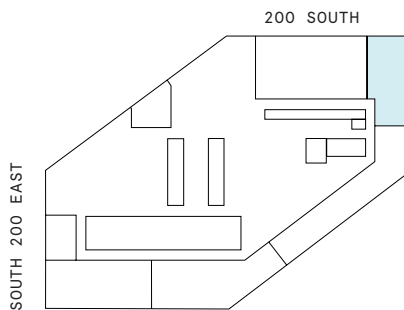

# Suite 15-111

## 15th Floor

1

MEETING ROOM(S)

2,185 RSF

RENTABLE AREA

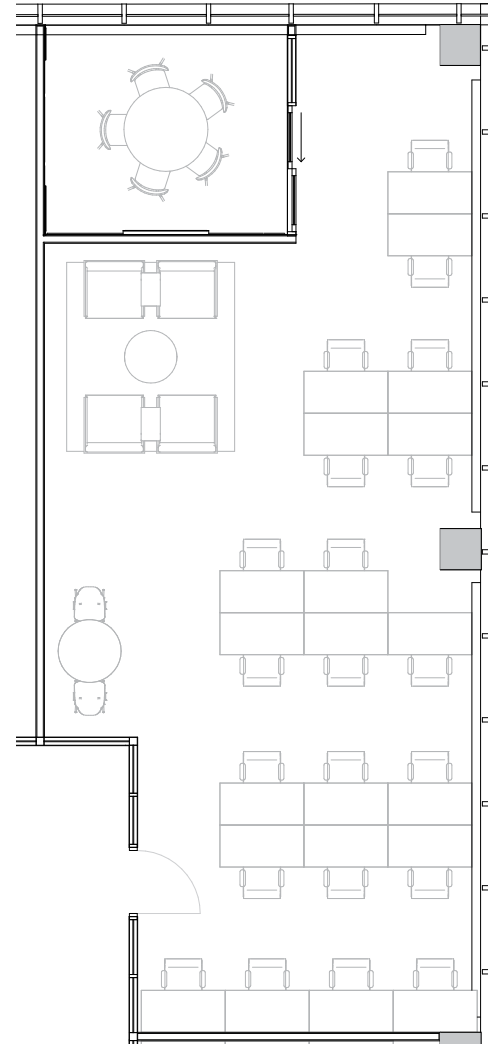
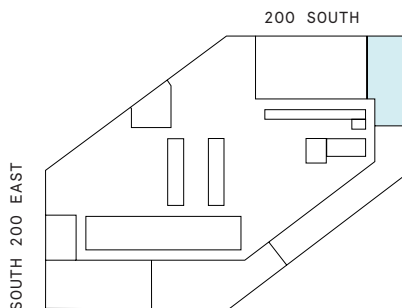



# 15th Floor

22,116 RSF

3,651 RSF Suite 15-128

1

MEETING ROOM(S)



200 SOUTH

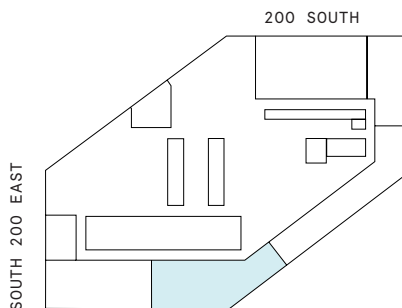

# Suite 15-128

## 15th Floor

1

MEETING ROOM(S)

3,651 RSF

RENTABLE AREA

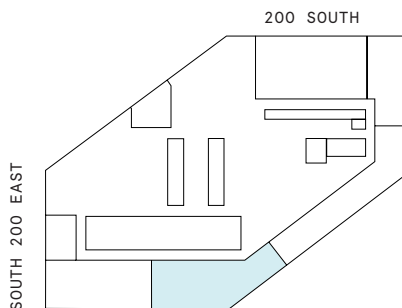
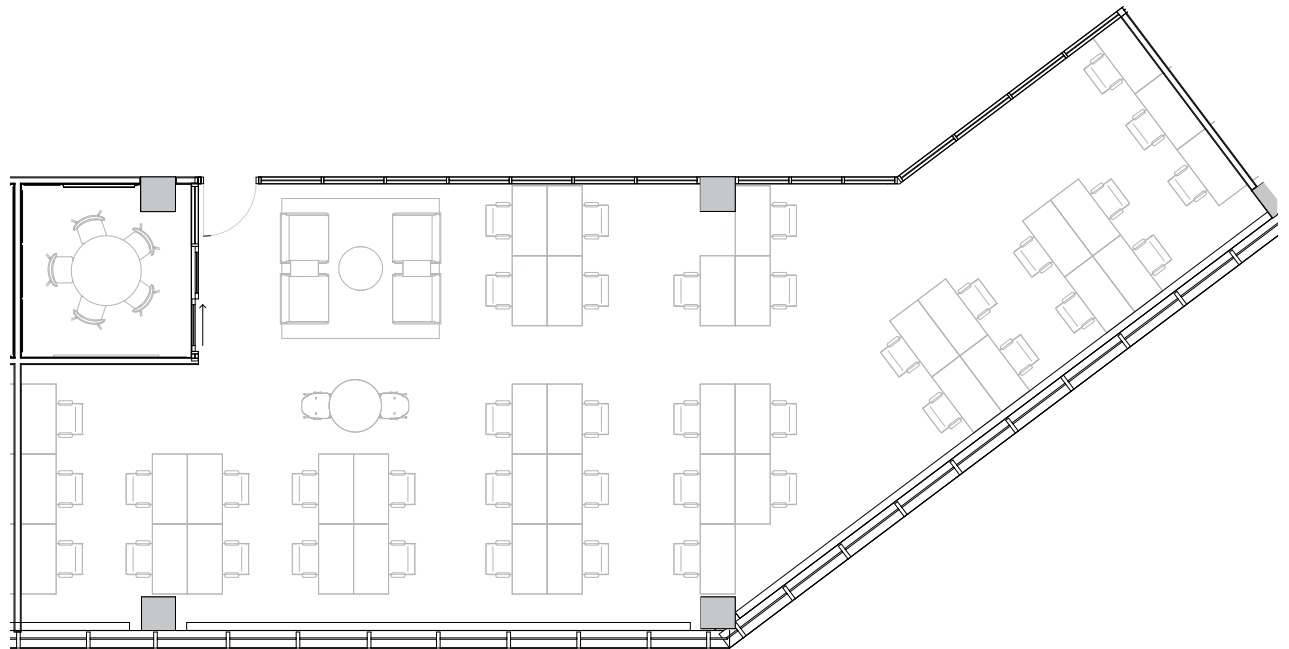



# 15th Floor

22,116 RSF

3,459 RSF Suite 15-131

1

MEETING ROOM(S)



200 SOUTH



SOUTH 200 EAST

200 SOUTH

SOUTH 200 EAST

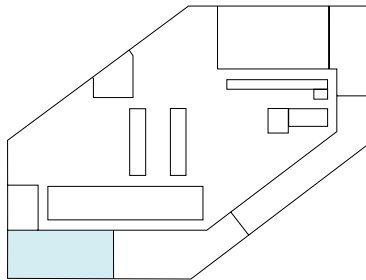

# Suite 15-131

## 15th Floor

1

MEETING ROOM(S)

3,459 RSF

RENTABLE AREA

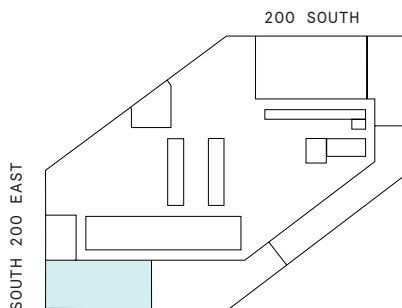
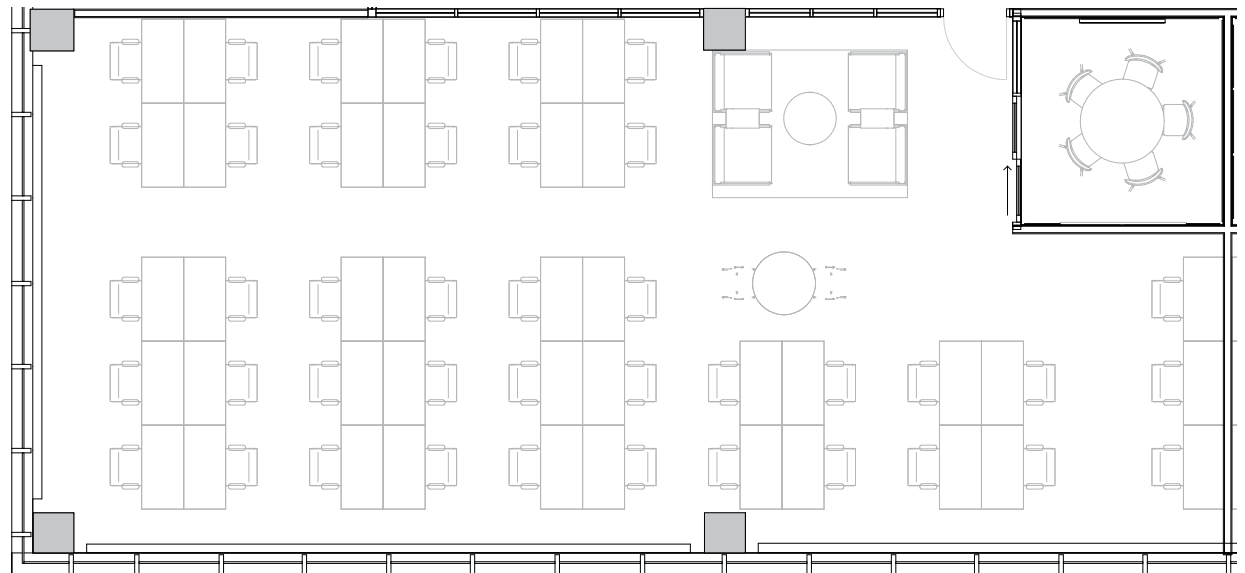

# 16th Floor

22,197 RSF

8

MEETING ROOM(S)

6

SHARED WORKSPACE(S)

## LEGEND

- MEETING ROOM
- SHARED WORKSPACE
- DEDICATED SPACE

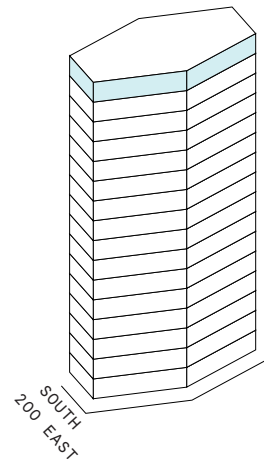

200 SOUTH

SOUTH 200 EAST

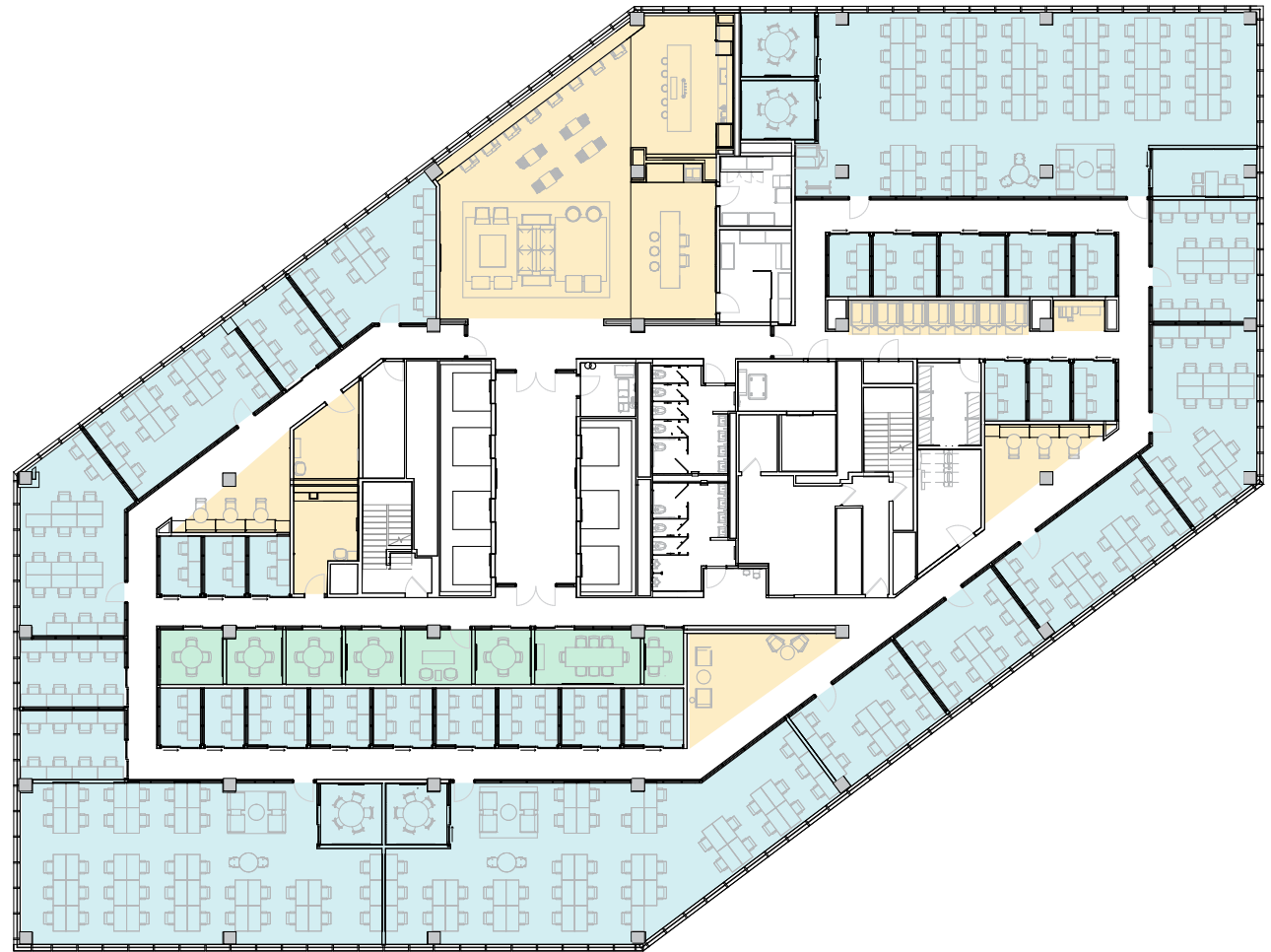



# 16th Floor

22,197 RSF

3,098 RSF Suite 16-113

1

MEETING ROOM(S)

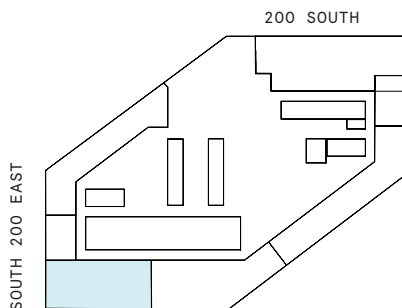

# Suite 16-113

## 16th Floor

1

MEETING ROOM(S)

3,098 RSF

RENTABLE AREA

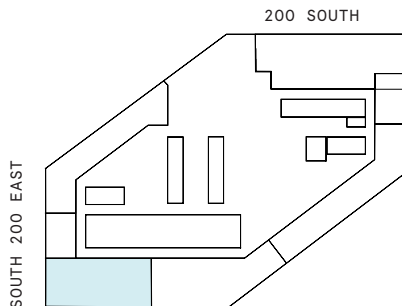
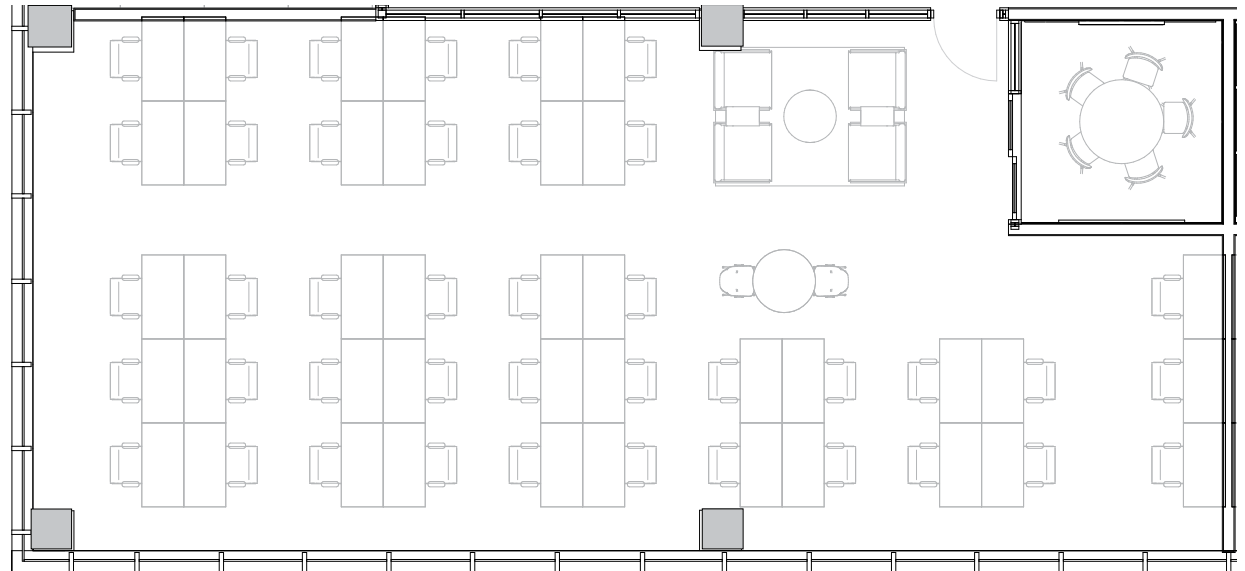

# 16th Floor

22,197 RSF

3,319 RSF Suite 16-116

1

MEETING ROOM(S)



200 SOUTH

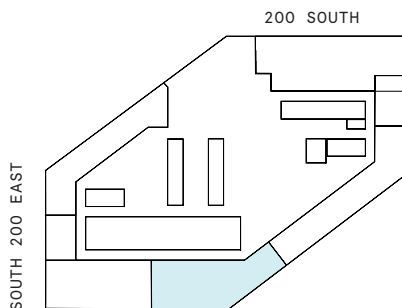



# Suite 16-116

## 16th Floor

1

MEETING ROOM(S)

3,319 RSF

RENTABLE AREA

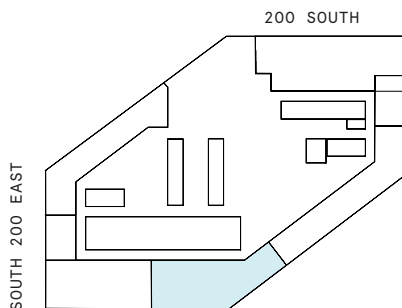
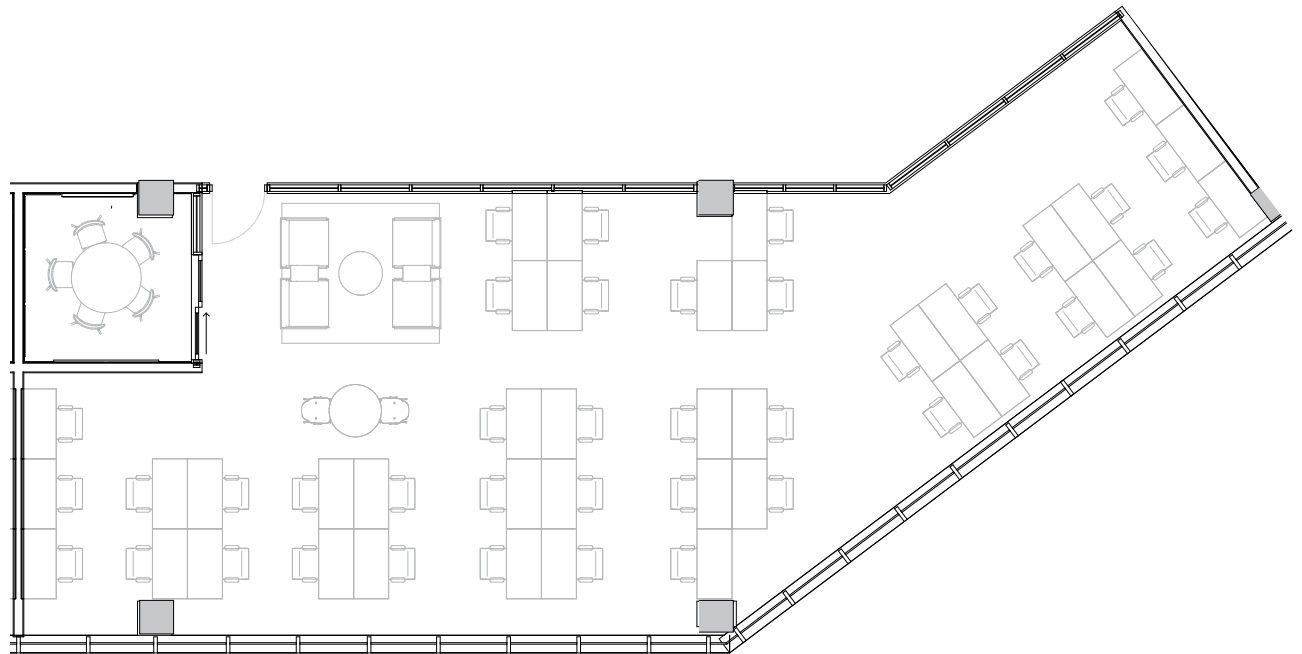

# 16th Floor

22,197 RSF

4,786 RSF Suite 16-129

2

MEETING ROOM(S)

1

PRIVATE OFFICE(S)



200 SOUTH

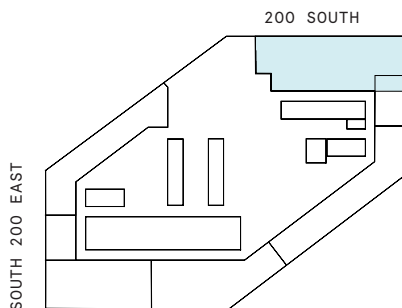

# Suite 16-129

## 16th Floor

2

MEETING ROOM(S)

1

PRIVATE OFFICE(S)

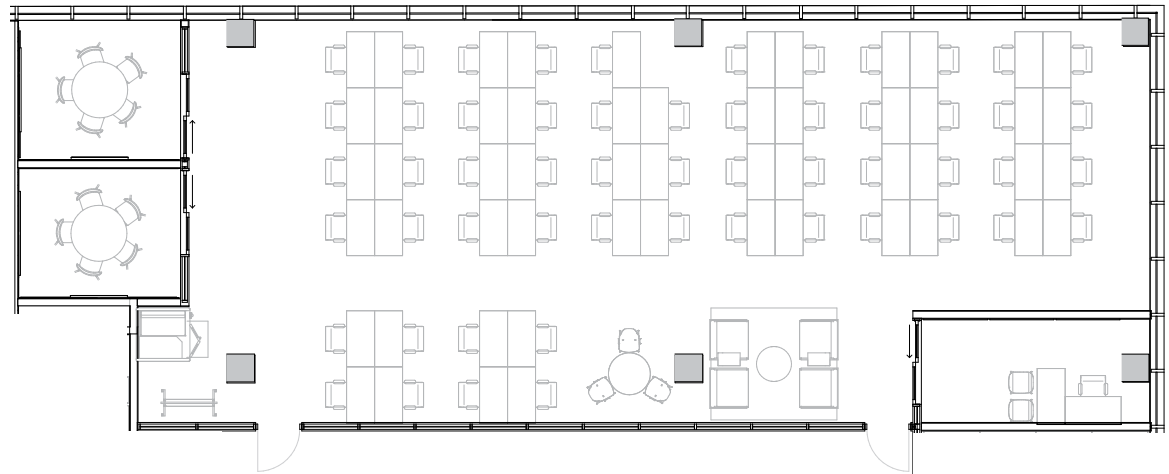

4,786 RSF

RENTABLE AREA

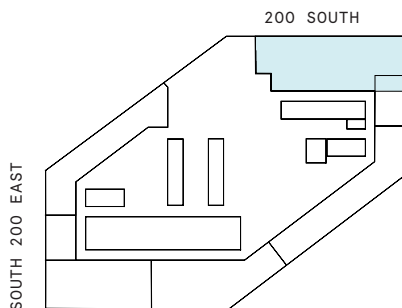



# Contact

---

Complete the form [linked here](#) to book a tour or connect with one of our team members.



© 2023 WeWork. The WeWork trademark and related logos are the property of WeWork Companies LLC. Any reference to third-party names are for reference and informational purposes only and should not be considered an endorsement or association of WeWork or vice versa. Photographs contained herein may be representative examples of various WeWork locations and do not necessarily depict the WeWork location referenced. While reasonable efforts have been made to check the accuracy of the information contained here, WeWork, its officers, employees, directors, and representatives, make no warranty, express or implied, regarding the accuracy of the information and disclaim any liability arising from the use of the information contained herein. All dimensions are approximate and subject to variances. It is your obligation to independently verify the particulars of the property. WeWork reserves the right to make changes.